



# **RIVA RACING**

**PERFORMANCE PRODUCTS & ACCESSORIES**

## **Intake Manifold Upgrade Kit**

**PART# - RY12040-IMUK**

**APPLICATION(S):** Yamaha FX-SHO & FZ Models (all)

**\*\*\* NOTE: Allow craft's engine to cool thoroughly before performing installation. \*\*\***

### **- INSTALLATION INSTRUCTIONS -**

1. Disconnect lanyard. Remove seats.
2. Remove plastic engine cover.
3. At right side of engine locate rubber hose between the intercooler and throttle body. (see illustration #1)
4. Remove bolt securing connecting pipe to engine. (see illustration #1) Loosen hose clamps and remove pipe. (see illustration #1)
5. At the front of the intake manifold remove bolt securing oil dip stick tube to manifold. (see illustration #2)
6. At underside of intake manifold remove the two bolts securing manifold to manifold support bracket. (see illustration #2)
7. At top of intake manifold remove the 2 cap nuts securing manifold to cylinder. (see illustration #2) Loosen the remaining six bolts securing intake manifold to cylinder. (see illustration #2)
8. Remove the four nuts and washers securing throttle body to throttle body joint. (see illustration #3) Pull intake manifold away from motor and remove throttle body.
9. Remove the four M8 bolts securing throttle body joint to intake manifold. (see illustration #3) Remove throttle body joint. **NOTE: Be careful not to lose or damage o-ring.** (see illustration #3)
10. Remove ribbon with holder from intake manifold inlet. (see illustration #3) Remove outer rubber holder and discard ribbon.
11. Place holder around outside of supplied billet sleeve. (see illustration #4 & 5) **NOTE: Direction of rubber holder in relation to marking on supplied billet sleeve is critical.**
12. Install billet sleeve with rubber holder into intake manifold inlet. (see illustration #5) **NOTE: Direction of supplied billet sleeve is critical. Arrow points to side that must face throttle body.**
13. Replace throttle body joint making sure o-ring is in place between joint and intake manifold. Secure with stock hardware. **NOTE: Apply blue Loc-tite to bolts. Torque to 13 N•m (9.6 ft•lbs).**
14. Replace throttle body making sure gasket is in place between throttle body and throttle body joint. Secure with stock hardware. **NOTE: Apply blue Loc-tite to bolts. Torque to 13 N•m (9.6 ft•lbs).**
15. Replace cap nuts and secure intake manifold to cylinder. **NOTE: Torque in sequence to 20 N•m (14.8 lbf•ft). Refer to illustration #2 for torque sequence.**
16. Replace the 2 bolts securing intake manifold to manifold support bracket and the 1 bolt securing oil dip stick tube to manifold. **NOTE: Apply blue Loc-tite to bolts. Do not over tighten bolts.**
17. Replace pipe connecting intercooler to throttle body. **NOTE: Do not over tighten clamps. Apply blue Loc-tite to bolt.**
18. Replace plastic engine cover. Installation is now complete!

***Remember, the water belongs to everyone. Please ride responsibly!***

## Technical Support

For answers to questions regarding installation or trouble shooting RIVA Performance Products contact:  
RIVA Technical Support directly at (954) 247-0705 or by e-mail at [tech\\_support@rivamotorsports.com](mailto:tech_support@rivamotorsports.com).

### Limited Warranty

RIVA Intake Manifold Upgrade Kits carry a 1-year limited warranty to the original purchaser. They are warranted to be free of defects in materials and workmanship under normal use and service. Customer modified components will be void of warranty. This warranty is limited to defects in the primary components only. Finish and/or wear marks in or on primary components are not covered under this warranty.

RIVA Racing's liability is expressly limited to the repair or replacement of the components contained within or associated with this kit. RIVA Racing agrees to repair or at RIVA's option, replace any defective unit without charge, if product is returned to RIVA Racing freight prepaid within the warranty period. Any equipment returned which, in RIVA's opinion, has been subjected to misuse, abuse, overheating or accident shall not be covered by this warranty.

RIVA Racing shall have no liability for special, incidental or consequential damages or injury to persons or property from any cause arising from the sale, installation or use of this product.

No other warranty, express or implied, including, but not limited to the implied warranties of merchantability and fitness for a particular purpose, applies. Various states do not allow for the limitation of incidental or consequential damages and therefore the above exclusion or limitation may not apply to you.

Warranty does not include the expenses related to freight or transportation of parts or compensation for any inconvenience or loss of use while being repaired. A copy of the original invoice and a Return Authorization Number (RA#) must accompany all warranty claims.

Warranted replacement parts will be returned freight collect.

## - INSTALLATION IMAGES -

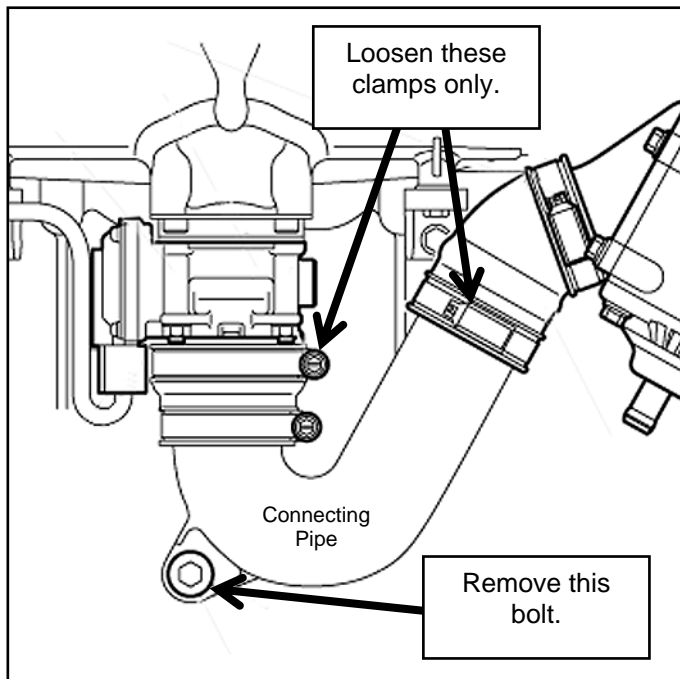

Illustration #1

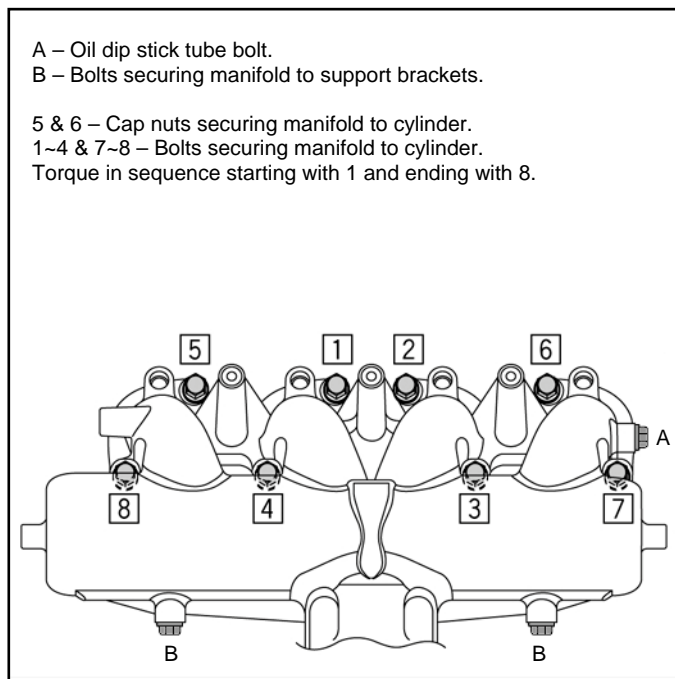

Illustration #2

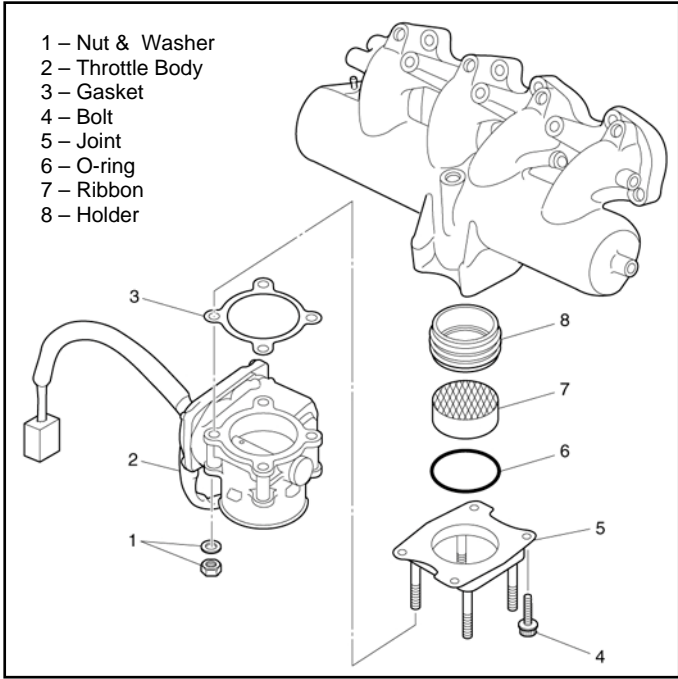

Illustration #3



Illustration #4

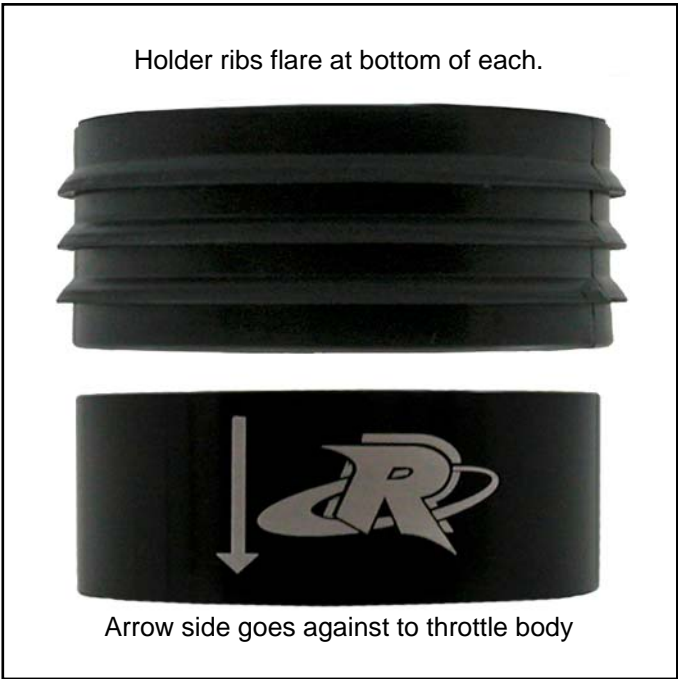

Illustration #5